

Studio Two

Manhattan

Large ground level studio with street access

Address

775 Washington St, New York, NY

Size

3,400 sq ft

Ceiling Height

13.5 ft (11.5 ft to ceiling trusses)

Light

Windows with black-out capability

Power

2x 100 amp 3-phase power

Additional

Ground level with street access, car accessible, can be combined with Studio 1.

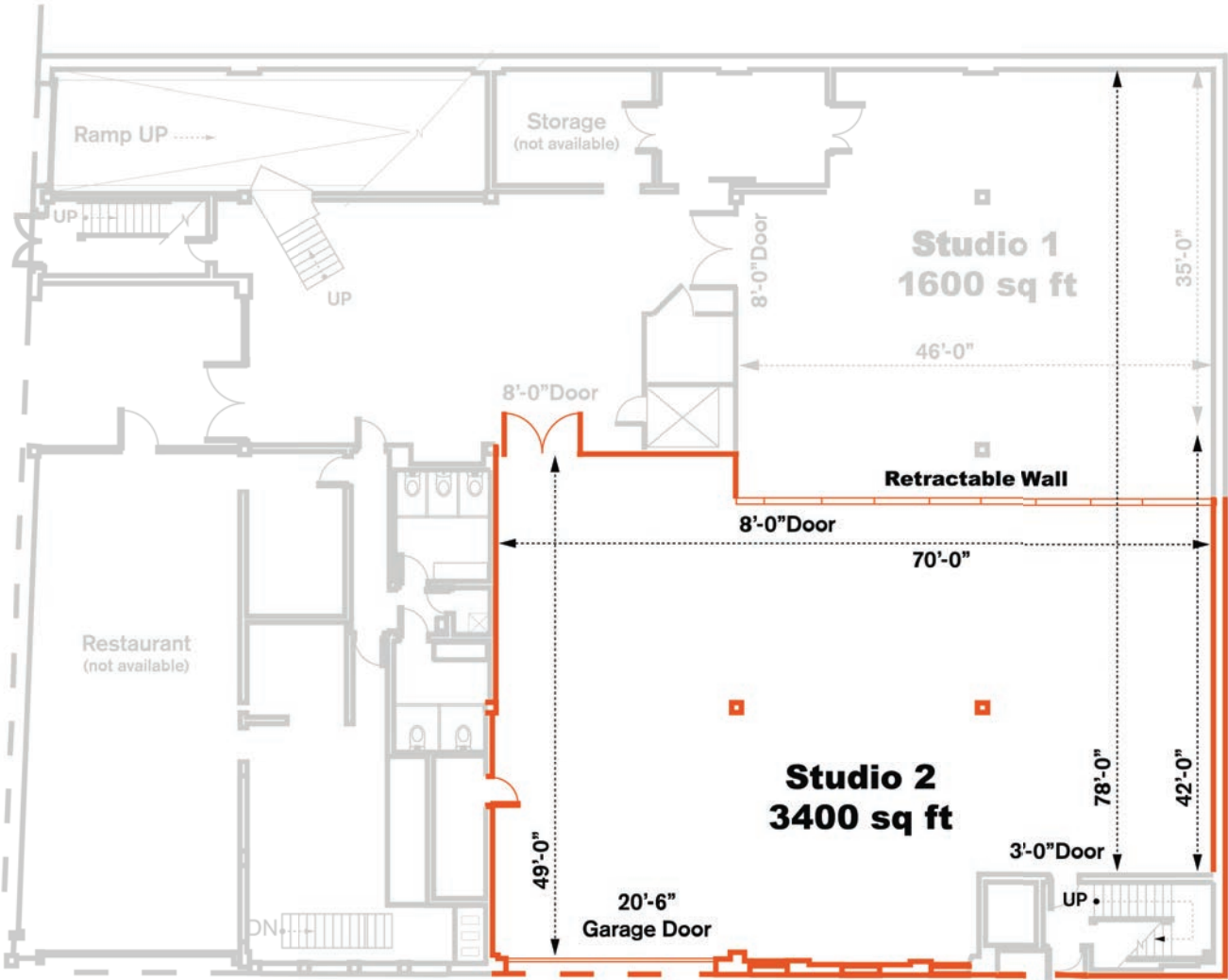

INDUSTRIA



INDUSTRIA



STUDIO 1 & 2 COMBINED/AIR-WALL OPEN